

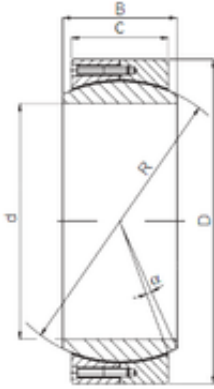

BEARING USA CORP.

560 mm x 750 mm x 258 mm ISO GE 560 QCR
plain bearings



Bearing No. GE 560 QCR

Size	560x750x258 mm
Bore Diameter	560 mm
Outer Diameter	750 mm
Width	258 mm
d	560 mm
D	750 mm
B	258 mm
C	215 mm
R	655 mm
Angle	4 °

GE 560 QCR Bearing 2D drawings and 3D CAD models