

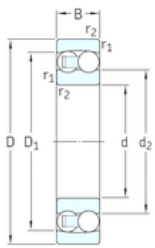

BEARING USA CORP.



Cylindrical bore



Tapered bore

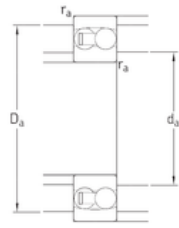

45 mm x 85 mm x 19 mm SKF 1209EKTN9 self aligning ball bearings

Bearing No. 1209EKTN9

1209EKTN9 Bearing 2D drawings and 3D CAD models

Size	45x85x19 mm
Bore Diameter	45 mm
Outer Diameter	85 mm
Width	19 mm
d	45 mm
D	85 mm
B	19 mm
C	19 mm
d2	57,5 mm
r1 min.	1,1 mm
r2 min.	1,1 mm
D1	73,7 mm
da min.	52 mm
Da max.	78 mm
ra max.	1,1 mm
Weight	0,47 Kg
Basic dynamic load rating (C)	22,9 kN
Basic static load rating (C0)	7,8 kN
Fatigue load limit (Pu)	0,4
Reference speed	17000 r/min
Limiting speed	11000 r/min
Calculation factor (e)	0,21
Calculation factor (kr)	0,04
Calculation factor (Y0)	3,2
Calculation factor (Y1)	3



BEARING USA CORP.