

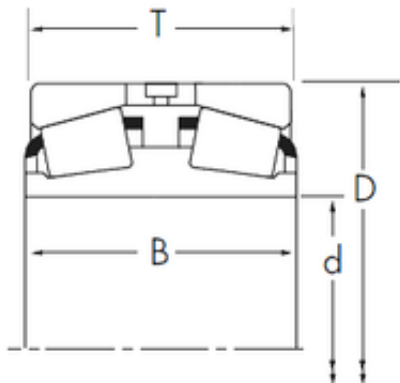

BEARING USA CORP.

36,512 mm x 72 mm x 38,1 mm Timken
19145D/19283 tapered roller bearings



Bearing No. 19145D/19283

Size	36.512x72x39.096 mm
Bore Diameter	36,512 mm
Outer Diameter	72 mm
Width	39,096 mm
d	36,512 mm
D	72 mm
T	39,096 mm
B	38,1 mm
R	0,8 mm
r	1,5 mm

19145D/19283 Bearing 2D drawings and 3D CAD models